



MARIANO MARCOS STATE UNIVERSITY

Bids and Awards Committee

INVITATION TO MAKE AN OFFER: Negotiated Procurement

2022-026-1

**THE PROJECT: CTE TVLED Building Center for Flexible Learning Hub Glass Partition, MMSU-CTE,
Laoag City, Ilocos Norte**
Number of Working Days: 45 calendar days
ABC: P300,827.63

1. The Mariano Marcos State University (MMSU), with offices at Quiling Sur, City of Batac, Ilocos Norte, invites the public to make an offer to furnish all labor, materials, tools and equipment necessary and proper for the implementation of the above Project as per approved designs, plans and drawings.
2. This process is in accordance with Section 53 of R.A. 9184, the Government Procurement reform Act and Section 53.9 of the Implementing Rules and Regulations where interested and qualified contractors are to submit proposals.
4. The offer must be in writing submitted at the address below not later than **5 days** together with the following documents:
 - a) The amount of the offer in writing duly signed by the person making the offer, indicated in numbers and figures.
 - b) The particulars of the offer as to labor, materials, tools, equipment and other work details.
 - c) Documents in support of the legal, technical and financial capability of the person making the offer, which documents shall be confirmed and verified (**3 copies**).
5. It is understood that any offer may be accepted or rejected, or the process invalidated, at any time prior to contract award, without liability to anyone.
6. Documents for this procurement may be secured from the MMSU BAC Secretariat at the address below or downloaded from the MMSU website or from the Philippine Government Electronic Procurement System (PhilGEPs) website.
7. For questions and inquiries, please write or email the University President, thru the BAC Chair, at the address indicated below.

Mariano Marcos State University
Quiling Sur, City of Batac
www.mmsu.edu.ph

September 29, 2022

NATHANIEL R. ALBUOYOS
BAC CHAIR

Received: _____

Received: _____

Republic of the Philippines
MARIANO MARCOS STATE UNIVERSITY
Batang City, Ilocos Norte

PROJECT INFORMATION DOCUMENT

Project Title : CTE TVLED Building Center for Flexible Learning Hub Glass Partition
Project Location : MMSU-CTE, Laoag City, Ilocos Norte

GENERAL INSTRUCTIONS

The project calls for the furnishing of all materials, labor, tools and equipment needed for the renovation of CTE TVLED Building Center. The proposed project is located at MMSU-CTE, Laoag City, Ilocos Norte. The said project shall be done in strict compliance with the designs, plans, drawings and other details, as well as the specifications for materials and workmanship for all scope of works, this Project Information Document and other related contract documents prepared and approved for this project.

It also calls for the employment of the required men power with the appropriate skills and expertise to undertake the specific items of work of this particular undertaking and to enable the contractor to produce and deliver to the satisfaction of the Owner the needed services and output required of this undertaking. It is a must as it is necessary that the contractor shall have regularly at the site a qualified Project Engineer to administer strictly the implementation of the project, including maintaining a log book of construction activities, as well as receiving authorized University Officials and Inspectors and a Safety Officer.

The contractor's license required for prospective contractors to undertake this project is at least a holder of **PCAB License with Principal Classification and Category which is under " License Category TRADE/E and with Size Range of SMALL-A"**.

General Instructions

Specifically the project covers the installation of glass and drywall partition is indicated in the plans and drawings.

The contractor shall ensure that the construction activities must not interfere, obstruct and disturb any adjoining rooms and hallways. In addition, the contractor shall be required to provide its own water and power supply system needed in the proper execution of the various works for the duration of the contract.

1. **MILLWORKS.** This item shall consist of furnishing of all materials, hardware, tools, labor and services necessary for the fabrication, delivery and installation of glass partition and aluminum glass door as shown in the Program of Works, specifications and drawings of the project. Sample of materials, design and color of the materials to be installed must be first approved by the PPDO and end-user prior to purchasing of the said item.

2. **DRY WALL PARTITION.** This scope of work includes the installation of 1/2" fiber cement board and Narra plywood on a metal frame system. The Contractor must submit samples of each needed materials as to specifications to PPDO Project In-Charge for approval before purchase and fabrication. Only approved materials shall be installed.

3. **PAINTING WORKS.** This scope of works includes the painting of drywall partition with two (2) coats of paints following the approved brand and quality of painting materials specified in the Program of Work and other related contract documents.

Supplementary Provisions

All other items or scope of works not mentioned in this document but shown/or indicated in the plans, drawings and specifications, except where it is specifically mentioned as "to be provided by others", the contractor shall likewise furnish all materials, labor and equipment necessary to complete the work.

In case of conflicts that will arise among specifications and quality of materials, installation procedure and in the plans and drawings as well as in the other contract documents before and during the implementation stage, the same should be referred to the end-user and PPDO Project In-charge for proper resolution of the said conflicts.

After all the works have been completed, the surrounding immediate areas affected in the prosecution of the project shall be cleaned and cleared of all excess materials and debris, temporary structures, facilities and utilities used during the construction period.

TIME is a very important factor in the implementation of this project and as such, all works indicated in the plans, specifications and this document shall be fully completed within **FORTY FIVE (45) CALENDAR DAYS** from the receipt of **Notice to Proceed**.

The Approved Budget for the Project to be bid is **Three Hundred Thousand Eight Hundred Twenty Seven Pesos and 63/100 (Php 300,827.63)**

Prepared by:

PAULINE V. PUYAAN
Engineering Assistant, CE

Checked/Reviewed by:

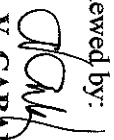
AIDA V. CABANG
Chief-PPS, Architect IV

ROMEO P. CASTILLO
Director, PPDO



Republic of the Philippines
MARIANO MARCOS STATE UNIVERSITY
City of Batac, 2906, Ilocos Norte

BILL OF QUANTITIES

Project Title: CTE TVLED Building Center For Flexible Hub Glass Partition
Project Location: MMSU-CTE, Laoag City, Ilocos Norte

ITEM NO.	DESCRIPTION	QUANTITY	UNIT
I	<u>Millworks</u> D1 - 10mm-thick Clear Tempered Frameless Glass Double Door With Frosted Sticker (2.10m x 1.60m) complete with accessories (i.e. Door handle, hinges etc.) D2 - 10mm-thick Clear Tempered Frameless Glass Door With Frosted Sticker (2.10m x 0.90m) complete with accessories (i.e. Door handle, hinges etc.) 10mm-thick Clear Tempered Glass Partition with Frosted Sticker on Analok Aluminum Frame (Conference Room) 10mm-thick Clear Tempered Glass Partition with Frosted Sticker on Analok Aluminum Frame (Office) 10mm-thick Clear Tempered Glass Partition with Frosted Sticker on Analok Aluminum Frame (Pantry)	1.00 1.00 2.00 13.14 7.32 5.40	lot set sets m ² m ² m ²
II	<u>Dry Wall Partition</u> 1/4" x 4'x8' Fiber Cement Board 1/4" x 4'x8' Narra Plywood Metal Studs Rivets 1" Metal Screw	32.70	m ²
III	<u>Painting Works</u> Concrete Sealer/Primer Patching Compound Semi Gloss Latex Varnish Consumables (% of Material Cost)	65.40	m ²

Prepared by:

PAULINE Y. PUYAOAN
Engineering Assistant

Checked by:

AIDA V. CABANIS
Architect IV, CHER-PPS

Recommending Approval:

ROMEO A. PAGSANJAN
Director - SPDO



Republic of the Philippines
MARIANO MARCOS STATE UNIVERSITY
City of Batac, 2906, Ilocos Norte

SPECIFICATIONS

Project Title: **CTE TVLED Building Center For Flexible Hub Glass Partition**
Project Location: **MMSU-CTE, Laoag City, Ilocos Norte**

ITEM NO.	DESCRIPTION
I	<u>Millworks</u> D1 - 10mm-thick Clear Tempered Frameless Glass Double Door With Frosted Sticker (2.10m x 1.60m) complete with accessories (i.e. Door handle, hinges etc.) D2 - 10mm-thick Clear Tempered Frameless Glass Door With Frosted Sticker (2.10m x 0.90m) complete with accessories (i.e. Door handle, hinges etc.) 10mm-thick Clear Tempered Glass Partition with Frosted Sticker on Analok Aluminum Frame (Conference Room) 10mm-thick Clear Tempered Glass Partition with Frosted Sticker on Analok Aluminum Frame (Office) 10mm-thick Clear Tempered Glass Partition with Frosted Sticker on Analok Aluminum Frame (Pantry)
II	<u>Dry Wall Partition</u> 1/4" x 4'x8' Fiber Cement Board 1/4" x 4'x8' Narra Plywood Metal Studs Rivets 1" Metal Screw
III	<u>Painting Works</u> Concrete Sealer/Primer Patching Compound Semi Gloss Latex Varnish Consumables (% of Material Cost)

Prepared By:

PAULINE PUYVAORAN
Engineering Assistant

Checked by:

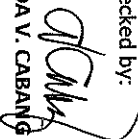
AIDA V. CABANG
Architect IV, Chief-PPS

Recommending Approval:

ROMEO R. ALDERSON
Director, PPDO



Republic of the Philippines
MARIANO MARCOS STATE UNIVERSITY
 City of Batac, 2906, Ilocos Norte

DETAILED ESTIMATES

Item No.: 1	Quantity: 1.00	
Description: Milworks	Unit:	lot

MATERIALS COST	Quantity	Unit	Unit Price	Sub-Total
" ¹⁰⁰⁰ " - D1 - 10mm-thick Clear Tempered Frameless Glass Double Door With Frosted Sticker (2.10m x 1.60m) complete with accessories (i.e. Door handle, hinges etc.)	1.00	set		-
" ¹⁰⁰⁰ " - D2 - 10mm-thick Clear Tempered Frameless Glass Door With Frosted Sticker (2.10m x 0.90m) complete with accessories (i.e. Door handle, hinges etc.)	2.00	sets		-
" ¹⁰⁰⁰ " - 10mm-thick Clear Tempered Glass Partition with Frosted Sticker on Analok Aluminum Frame (Conference Room)	13.14	sq.m		-
" ¹⁰⁰⁰ " - 10mm-thick Clear Tempered Glass Partition with Frosted Sticker on Analok Aluminum Frame (Office)	7.32	sq.m		-
" ¹⁰⁰⁰ " - 10mm-thick Clear Tempered Glass Partition with Frosted Sticker on Analok Aluminum Frame (Pantry)	5.40	sq.m.		-
<i>"¹⁰⁰⁰" - Note: Item of Work includes materials, delivery and installation</i>				
Total Materials Cost			Sub-Total	-
			Unit Cost	-
Description	No. of Units	No. of Hours/\$	Hourly Rate	Sub-Total
Total Equipment Cost			Sub-Total	-
			Unit Cost	-
Description	No. of Persons/s	No. of Hours/s	Hourly Rate	Sub-Total
Total Labor Cost			Sub-Total	-
			Unit Cost	-

DIRECT COST: -
 DIRECT UNIT COST: -

Plus Indirect Cost:
 OCM -
 CP -
 VAT -
 INDIRECT COST: -
 INDIRECT UNIT COST: -

Total Direct and Indirect Cost: -



Republic of the Philippines
MARIANO MARCOS STATE UNIVERSITY
 City of Batac, 2906, Ilocos Norte

DETAILED ESTIMATES

Item No.:	II	Quantity:	32.70
Description:	Dry Wall Partition	Unit:	sq.m.

MATERIALS COST	Quantity	Unit	Unit Price	Sub-Total
1/4" x 4x8' Fiber Cement Board		pcs		-
1/4" x 4x8' Narra Plywood		pcs		-
Metal Studs		pcs		-
Rivets		pcs		-
1" Metal Screw		pcs		-
Total Materials Cost			Sub-Total	-
			Unit Cost	-

EQUIPMENT COST	No. of Units/	No. of Day/s	Daily Rate	Sub-Total
Minor Tools (% of Labor Cost)				
Total Equipment Cost			Sub-Total	-
			Unit Cost	-

LABOR COST	No. of Person/s	No. of Day/s	Daily Rate	Sub-Total
Construction Foreman				
Skilled Laborer				
Unskilled Laborer				
Total Labor Cost			Sub-Total	-
			Unit Cost	-

DIRECT COST: -
 DIRECT UNIT COST: -

Plus Indirect Cost:
 % OCM -
 % CP -
 % VAT -

INDIRECT COST: -
 INDIRECT UNIT COST: -

Total Direct and Indirect Cost: -



Republic of the Philippines
MARIANO MARCOS STATE UNIVERSITY
 City of Batang, 2906, Ilocos Norte

DETAILED ESTIMATES

Item No.: III	Quantity:	65.40
Description: Painting Works	Unit:	sq.m.

MATERIALS COST	Quantity	Unit	Unit Price	Sub-Total
Concrete Sealer/Primer		gals		-
Patching Compound		gals		-
Semi Gloss Latex		gals		-
Varnish		litre		-
Consumables (% of Material Cost)				-
Total Materials Cost			Sub-Total	-
			Unit Cost	-

EQUIPMENT COST	No. of Units	No. of Days	Daily Rate	Sub-Total
Minor Tools (% of Labor Cost)				-
Total Equipment Cost			Sub-Total	-
			Unit Cost	-

LABOR COST	No. of Persons	No. of Days	Daily Rate	Sub-Total
Construction Foreman				
Skilled Laborer				
Unskilled Laborer				
Total Labor Cost			Sub-Total	-
			Unit Cost	-

DIRECT COST: -
 DIRECT UNIT COST: -

Plus Indirect Cost:

OCM -
 CP -
 VAT -

INDIRECT COST: -
 INDIRECT UNIT COST: -

Total Direct and Indirect Cost: -

SHIRLEY C. ARRUPIS UNIVERSITY PRESIDENT <i>[Signature]</i>	ROMEO R. DULDULAO DIRECTOR, PDDO <i>[Signature]</i>	AIDA V. CABANG ARCHITECT IV, CHIEF, PHYSICAL PLANNING SECTION <i>[Signature]</i>	PREPARED BY:
APPROVED BY:	RECOMMENDING APPROVAL:	CHECKED/REVIEWED BY:	ARIEL ART B. ADAJAR APPRENTICE <i>[Signature]</i>
SHEET NO:	CONFORME:	PROJECT TITLE:	DRAWN BY:
SHEET CONTENT:	DEAN, CTE ARIS REYNOLDO V. CAJIGAL <i>[Signature]</i>	CTE TVLED BUILDING CENTER FOR FLEXIBLE LEARNING HUB	LOCATION: MMSU-CTE LAOG, LOCOS NORTE



FLOOR PLAN

SCALE: 1:100m

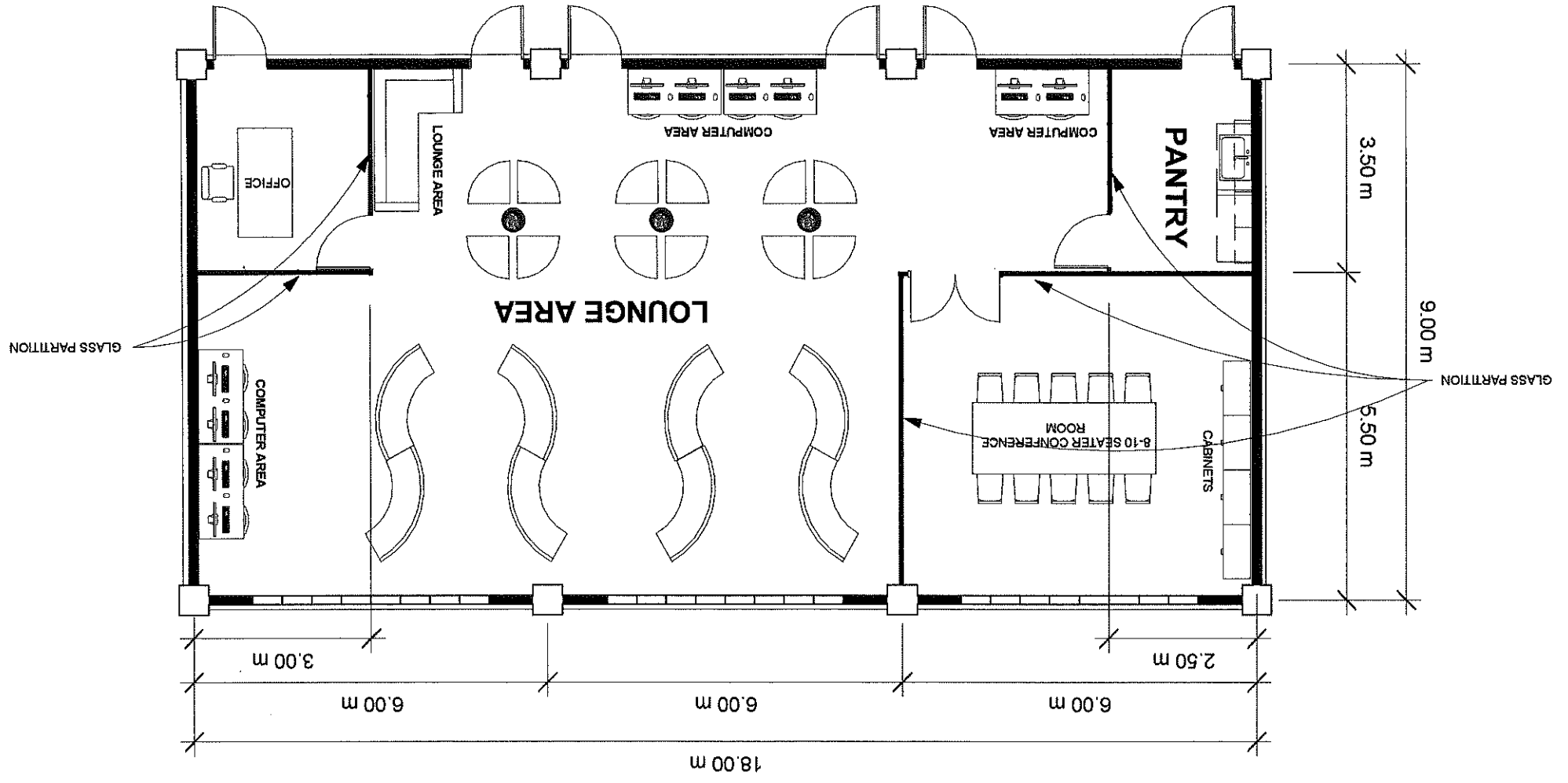



ARIEL ART B. ADAJAR
APPRENTICE

PROJECT TITLE: CTE TVLED BUILDING CENTER FOR FLEXIBLE LEARNING HUB
GLASS PARTITION

ARIS REYNOLB V. CAJIGAL
DEAN, CTE

DRAWN BY: ARIEL ART B. ADAJAR
PROJECT TITLE: CTE TVLED BUILDING CENTER FOR FLEXIBLE LEARNING HUB
GLASS PARTITION
CONFORME: ARIS REYNOLB V. CAJIGAL
SHEET CONTENT:
SHEET NO.:

CHECKED/REVIEWED BY: AIDA V. CABANG
ARCHITECT IV, CHIEF-PHYSICAL PLANNING SECTION

RECOMMENDING APPROVAL: ROMEO R. DULDUAO
DIRECTOR, PBO

APPROVED BY: SHIRLEY C. ARRUPIS
UNIVERSITY PRESIDENT

GLASS PARTITION FOR OFFICE

SCALE: 1:100M

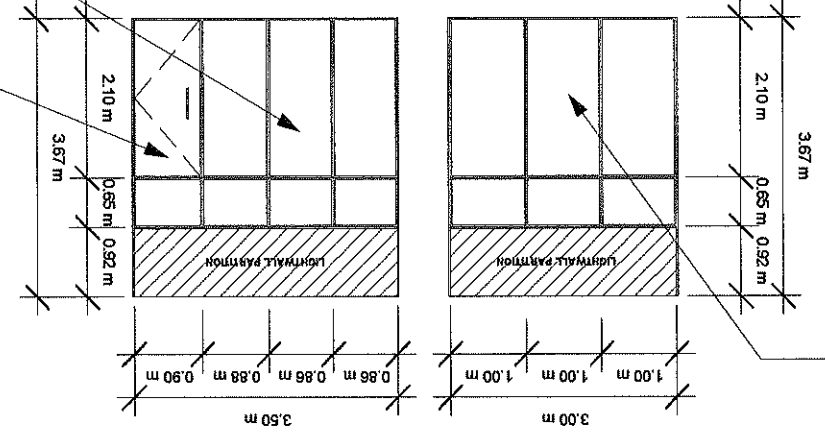

10mm CLEAR TEMPERED GLASS PARTITION WITH FROSTED STICKER ON (ANALOK) ALUMINUM FRAME

GLASS PARTITION FOR CONFERENCE ROOM

SCALE: 1:100M

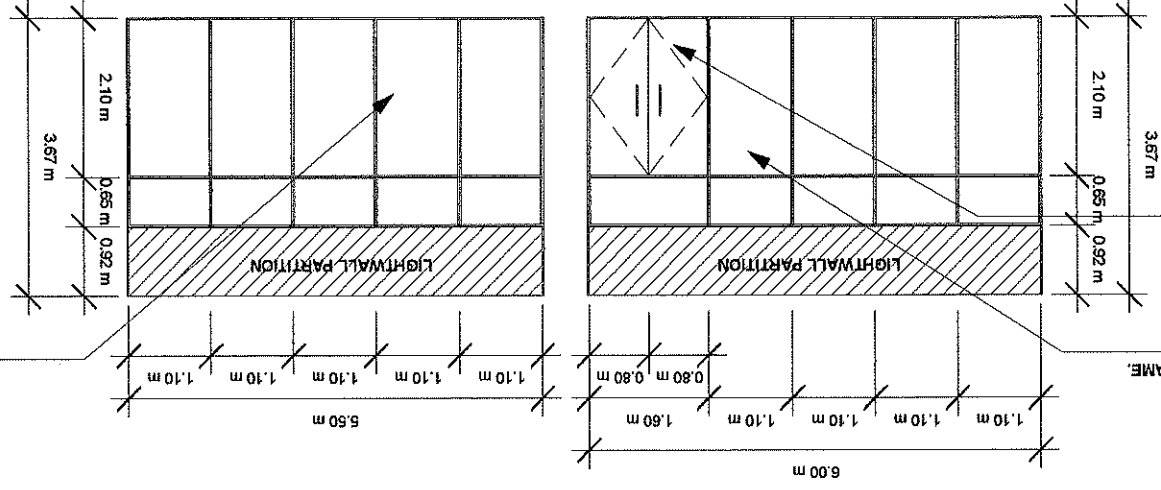

10mm CLEAR TEMPERED FRAMELESS GLASS DOOR WITH FROSTED STICKER (FLOOR-MOUNTED HINGE)

10mm CLEAR TEMPERED GLASS PARTITION WITH FROSTED STICKER ON (ANALOK) ALUMINUM FRAME

GLASS PARTITION FOR PANTRY

SCALE: 1:100M

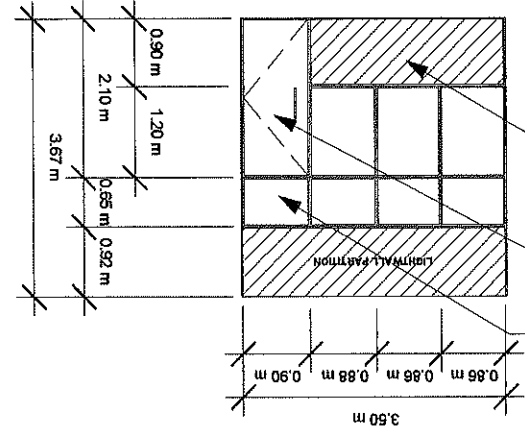

10mm CLEAR TEMPERED FRAMELESS GLASS DOOR WITH FROSTED STICKER (FLOOR-MOUNTED HINGE)

1/4" THICK NARRA PLYWOOD (VARNISHED)

10mm CLEAR TEMPERED GLASS PARTITION WITH FROSTED STICKER ON (ANALOK) ALUMINUM FRAME